

# STATEMENT OF QUALIFICATIONS TRAFFIC ENGINEERING SERVICES

## WOODLAND SCHOOL DISTRICT/ HIGH SCHOOL

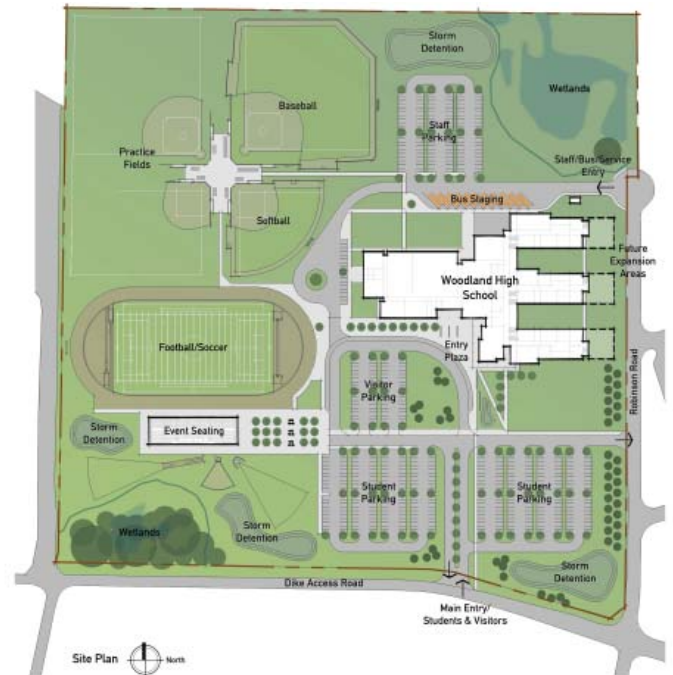

*Conceptual Courtesy of McGranahan Architects*

May 2, 2012

engineers  
—  
landscape architects  
—  
planners  
—  
surveyors

VANCOUVER - 300 W. 15th Street - Vancouver, WA 98660 - 360/695-3488 - 360/695-8767f  
PASCO - 6115 E. Burden Blvd., Suite E - Pasco, WA 99301 - 509/547-5119 - 509/547-5129f  
[www.hjdgroup.com](http://www.hjdgroup.com)





May 2, 2012

**SERVICES:**

Traffic Engineering  
Civil Engineering  
Planning  
Landscape Architecture  
Geotechnical Engineering  
Surveying  
Construction Management

Michael Green  
Superintendent  
Woodland School District  
800 Third Street  
Woodland, WA 98674

RE: Statement of Qualifications – Traffic Engineering Services

Dear Mr. Green:

Please accept this document as our proof of interest and availability to do business with the Woodland School District for Traffic Engineering services for the new Woodland High School.

**VANCOUVER OFFICE:**

300 W 15th Street  
Vancouver, WA 98660-2927  
360/695-3488  
360/695-8767 fax

HDJ Design Group, PLLC is an experienced and highly qualified traffic and civil engineering firm with a long history of excellent service to clients throughout Washington and Oregon. As a local Vancouver firm, we employ twenty-three engineers, designers and technicians. Since it's inception in 1980 HDJ has been committed to helping build stronger communities by providing outstanding consulting services. Located at 300 W. 15th Street, Vancouver, WA, HDJ is a multi-talented professional consulting firm, within a short drive to the Woodland area.

**PASCO OFFICE:**

6115 Burden Blvd. - Ste E  
Pasco, WA 99301  
509/547-5119  
509/547-5129 fax

Senior traffic engineers here at HDJ, have provided traffic engineering studies to a wide variety of educational clients over the years. Most recently this has included the preliminary traffic capacity analysis for the Woodland High School site prior to the bond approval in 2012. Other educational clients have included: On-Call for the Battle Ground School District for Traffic Engineering, the Vancouver School District (Washington Elementary, Hough Elementary, Roosevelt Elementary, Odgen Elementary, Hudson Bay High, For Vancouver High), Evergreen School District (Ellsworth Elementary, Marion Elementary, Fircrest Elementary, Mt. View High, Evergreen High, Illahee Elementary, Fisher's Landing Elementary) as well as Clark College, City of Sherwood School District, Ridgefield School District, the Firm Foundation Christian School and recently Reynolds School District for Multnomah County. From school traffic management, school zone signing, traffic impact analysis, parking lot design, traffic calming and pedestrian safety improvements, the HDJ traffic engineers look forward to providing this same expertise to the Woodland School District.

HDJ as a firm has performed work directly for the Woodland School District, the City of Woodland, and the Port of Woodland. Engineers, designers and traffic engineers have worked on over 20 projects within the Woodland area for public and private development, giving the HDJ team the expertise to deliver successful projects on-budget and on-time. A few of the past projects handled by HDJ specifically for the City of Woodland have included traffic and design engineering are: Davidson Avenue, Bozarth Avenue and now currently the SR-503 Channelization and Widening project for the City.

Proposed key staff who are immediately available to work for the school district include: Thomas W. Dennis, Principal-In-Charge, John A. Manix, P.E., P.T.O.E., Senior Traffic Manager, Jeffrey R. Wise, P.E., P.T.O.E., Senior Traffic Engineer / Advisory Traffic Support and Larry Gifford, Traffic Designer.

HDJ is ready to start immediately on this new high school for the Woodland School District and are committed to making them our highest priority.

Sincerely,  
HDJ Design Group, PLLC

Thomas W. Dennis, P.E.  
Principal-In-Charge

**HDJ Design Group, PLLC (HDJ)** has been providing professional consulting services to the communities of the Northwest for over thirty-two years. Since its inception in 1980, HDJ Design Group has been committed to helping build stronger communities by providing outstanding service to both public and private sector clients. HDJ also recognizes the impact it has on the community through the accomplishments and involvement of its employees. HDJ strives to create a working environment that allows their staff to achieve both personal and professional goals. HDJ Design Group is a Traffic Engineering, Civil Engineering, Planning, Landscape Architecture, Land Surveying, Project Management and Construction Services consulting firm. HDJ staffs are licensed in Washington and Oregon, and have performed work on projects throughout the Pacific Northwest. HDJ has an outstanding reputation for delivering the highest quality products.

The HDJ Traffic Team can provide the traffic engineering services needed by the Woodland School District including:

- Traffic impact studies
- On and off site traffic analysis
- Traffic, pedestrian and Bicycle Safety Analysis
- Illumination Design

Further, the HDJ Team knows how these highly technical analyses and results can be successfully presented to a variety of audiences including School Boards and Commissions, Parent/ Teacher Associations, Hearings Examiners and Neighborhood Associations.

HDJ's reputation is based on its depth and range of experience, problem-solving and communication skills, responsiveness and integrity. With over 3,400 projects completed and/or in progress, HDJ has the knowledge, skill and resources to meet the demands of tomorrow's public developments.



## **CORPORATE OFFICE:**

300 W 15th Street  
Vancouver, WA 98660-2927  
360/695-3488  
360/695-8767 fax

## **PASCO OFFICE:**

6115 Burden Blvd., Suite E  
Pasco, WA 99301-8930  
509/547-5119  
509/547-5129 fax

## Firm Services

### **CIVIL ENGINEERING**

- Traffic Engineering
- Transportation Engineering
- Site Development
- Residential Development
- Utility Master Planning
- Educational/Medical/Religious
- Office/Commercial/Retail
- Urban Infill
- Mixed-Use

### **LAND SURVEYING**

- Topographic
- Boundary
- ALTA Survey
- Platting Services
- Construction Survey

### **GEOTECHNICAL ENGINEERING**

- Geohydrology
- Engineering Geophysics

### **LANDSCAPE ARCHITECTURE**

- Park Design & Planning
- Planting & Irrigation Design
- Site / Urban Design

### **LAND USE PLANNING**

- Feasibility Studies
- Master Planning
- Development Review
- Transportation Planning

### **PROJECT MANAGEMENT & CONSTRUCTION SERVICES**

## Previous Experience – Traffic Engineering



Conceptual Courtesy of  
McGranahan Architects

### WOODLAND HIGH SCHOOL CAPACITY ANALYSIS

**Location:** Woodland, WA

**Client:** Michael Green, Superintendent– Woodland School District

**Work Services Provided:** Capacity Analysis for Proposed New High School

HDJ was hired to examine the traffic analysis in the vicinity of a proposed new High School on Dike Road. The study discussed the Level of Service, the current state of approved development and associated street improvements, estimated the expected trip general from the High School and then examined the operation of key intersection in terms of “Level of Service”. Intersections that the analysis examined were Dike Road and Robinson Rd., Dike Road and Schurman Way, Dike Road and I-5 Southbound ramps and the Dike Road and I-5 Northbound Ramps. The study also examined traffic with the High school plus approved developments in the vicinity of the school for both High School Peak Hour and for the general 4-6pm peak hour. The study also looked at 2025 projected traffic volumes from the Cowlitz-Wakiakum Council of Governments. The study was completed in 2010.

### RIDGEFIELD SCHOOL DISTRICT

**Location:** Ridgefield, WA

**Client:** Art Edgerly, Superintendent– Ridgefield School District #112 – 360/619-1302

**Work Services Provided:** Safety Route to School Study

HDJ Design Group has been providing civil engineering on-call services for the Ridgefield School District since 2005.

HDJ has provided on-call services for modulars for the following schools in Ridgefield: Union Ridge Elementary - Ridgefield High School - South Ridge Modulars

In 2010 HDJ was awarded the on-call engineering services contract once more and provided Ridgefield School District with preliminary design and traffic analysis for proposed improvements to the View Ridge / Union Ridge campus.

### UNION HIGH SCHOOL

**Location:** Vancouver, WA

**Client:** Sue Steinbrenner – Executive Director of Facilities – Evergreen Public Schools – 360/604-4077

**Work Services Provided:** Traffic Engineering, Civil Engineering, Landscape Architecture

HDJ Design Group, under Jeff Wise’s management, provided extensive traffic engineering services. This included facilitating the Traffic Advisory Committee for a new high school, later to be named Union High, preparation of a circulation plan, a traffic impact study, signing, striping and street light design. Due to the substantial traffic concerns, this required submitting and receiving approval of a road modification request, collecting additional traffic counts beyond those required for the Traffic impact analysis and supplementary determination on the rational necessary for installing two traffic signals. Clark County required additional analysis to show how the proposed traffic signal will mitigate the level of service failure at several intersections. This project required coordination with 3 local agencies, City of Camas, Clark County and the City of Vancouver.

### FIRM FOUNDATION CHRISTIAN SCHOOL EXPANSION PROJECT

**Location:** Vancouver, WA

**Client:** David Commeree, DLC Architecture, LLC – 360/601-9858

**Work Services Provided:** Traffic Analysis

HDJ staff prepared the traffic impact analysis to address the City of Battle Ground land use planning requirements. This included addressing the school impacts on adjacent intersections in Battle Ground.



## MULTNOMAH COUNTY SCHOOL REVIEW

**Location:** Multnomah County, OR

**Client:** Brian Vincent, County Engineer – Multnomah County – 503/998-5050 ext. 29642

**Work Services Provided:** *Traffic Safety Reports for Terra Nova High School and Reynolds Learning Center*

HDJ provides on-call traffic engineering services for Multnomah County and has recently prepared traffic safety reports for two schools: Reynolds Learning Academy and Terra Nova High School. This work included meeting with the school, district and sheriff department staff to address pedestrian and traffic concerns.

The School Safety Reviews recommended short term and long term pedestrian enhancements at Reynolds Learning Academy and additional low cost safety improvements at Terra Nova School.

By completing the analysis at Terra Nova High School and Reynolds Learning Center, HDJ staff was able to address safety concerns at the multi-sensory learning academy with recommended low cost school zone sign improvements.

## AMBOY MIDDLE SCHOOL

**Location:** Amboy, WA

**Client:** Kevin Jolma, Dir. of Operations– Battle Ground School District – 360/885-6677

John Morris, Cap. Projects Manager– Battle Ground School District – 360/885-6626

**Work Services Provided:** *Traffic Study*

This project was a traffic study for adding new buildings to an existing middle school complex. It also addressed a master plan for a new high school.

Traffic engineering was provided for this project and included meeting with staff, preparation of a trip generation report based on an examination of the existing trips, estimation of future trips from the new buildings, and site access analysis which addressed an intersection sight distance issue.

The study done by HDJ traffic engineers recommended that the school zone be extended to lower speeds in the vicinity of the site access. A traffic study was prepared for the Clark County Review as part of the conditional use permit.

## BATTLE GROUND SCHOOL DISTRICT MASTER PLAN

**Location:** Battle Ground, WA

**Client:** Kevin Jolma, Dir. of Operations– Battle Ground School District – 360/885-6677

John Morris, Cap. Projects Manager– Battle Ground School District – 360/885-6626

**Work Services Provided:** *Traffic Study for new construction*

This project involved a traffic study to reserve trips for the School District plan involving the construction of a new K-8 school, a new middle school, removal of an existing K-8 facility, an addition to an existing K-8, revisions to a high school, and conversion of a school into an office/maintenance building for the school district.

Traffic engineering on this project included a traffic study for this multi-jurisdictional project with schools in Clark County and City of Battle Ground. A letter confirming the scope for all parties was prepared and accepted before work was started.

The trip distribution was complex, considering not only the distribution of new trips from the schools, and the change in traffic patterns as existing trips were diverted to new locations. The need for left turn lanes and the adequacy of the storage for existing turning lanes was examined at all connections to the public street system. The need for off-site mitigation to resolve capacity and safety issues was also completed.

In response to a request by the City of Battle Ground, the need for a new roadway for circulation between two of the schools was considered as part of the plan.

HDJ's engineers provided a traffic study for agency review and support for the public hearing.





### AREA 59 CONCEPT PLAN - TRAFFIC STUDY

**Location:** Sherwood, OR

**Client:** Julia Hajduk, Planning Supervisor, City of Sherwood – 503/625-4202

**Work Services Provided:** *Traffic Study for Internal Circulation and Traffic Patterns*

Area 59 is an 85-acre site designated by Metro for inclusion in the Sherwood Urban Growth Boundary in 2002. The conceptual plan included new middle and elementary schools and a mix of housing and open space.

The Sherwood City Council appointed an Area 59 Citizens Advisory Committee (CAC) in 2004, to provide public input. The City also organized a project team of agency staff to offer technical advice during the development of Area 59.

HDJ prepared a traffic study to examine internal circulation and traffic patterns through a neighborhood to the proposed schools. The study also looked at roadway classification and identified access points. Key off-site arterial intersections impacted by the development were also studied. The study predicted traffic patterns resulting from construction of the new school and then estimated new trips from the Area 59 Concept Plan. These numbers were added to traffic volumes from the Sherwood Transportation System Plan to identify impacts. This process was done for each of the alternatives identified by the CAC. HDJ presented their findings to the project team and updated the study in accordance with the team’s recommendations.



### NE 192ND AVENUE & NE 13TH STREET SIGNAL

**Location:** Clark County, WA

**Client:** Reg Martinson, Exe. Director of Facilities – Evergreen Public Schools  
– 360/604-4077

**Work Services Provided:** *Traffic Engineering, Signal Design*

A new signal system was designed and constructed at the intersection of NE 192nd Avenue (a principal arterial) and NE 13th Street (a collector arterial) in Clark County, Washington. The signal system was required as part of the development for a new high school. The signal alleviates intersection capacity issues, as well as providing a safe road crossing between adjoining neighborhoods and a large park sports complex.

HDJ’s design of the signal was coordinated in an effort to meet current County standards with concessions to the City for future annexation and operation. The project also included the addition of a turning lane on NE 192nd Avenue, designed to accommodate plans for future roadway widening.



### CEDAR TREE CHRISTIAN CLASSICAL SCHOOL

**Location:** Clark County, WA

**Client:** Cedar Tree Christian Classical School – P.O. Box 65520 – Vancouver, WA  
98665 – 360/574-0047

**Work Services Provided:** *Traffic Engineering*

This project is a new private school with associated parking, landscaping and utilities, in Clark County, Washington. The project required SEPA, Site Plan Review and Conditional Use Permit approval under a Type III process in accordance with Clark County standards.

HDJ provided traffic engineering, land use planning, civil engineering and landscape architectural services to support development of the project. The project is proposed to be constructed over approximately 15.4 acres of land. The development will consist of approximately five phases of construction. The first two phases of development have been completed and include the site infrastructure and modular, portable classrooms. Phases three through five provide for the phased construction of a permanent structure.

Traffic engineering on this project included meetings and coordination with Client and team members, preparation of trip generation and trip distribution, analysis of level of service and site access and study of intersections. Engineers also provided analysis of signal warrants/turn lane warrants, site distance verifications for site ac-

cess, negotiated with WSDOT and County staff for the scoping of acceptable off-site traffic mitigation measures and prepared a TIA Report detailing existing conditions, project traffic and future conditions at the studied intersections.

### **ILLAHEE ELEMENTARY SCHOOL\***

**Location:** Vancouver, WA

**Client:** Ali Eghtedari, Traffic Engineering Manager, City of Vancouver – 360/487-7705

**Work Services Provided:** *Traffic Engineering*

Illahee Elementary School in the Evergreen School District is located on SE 1st St just east of SE 192nd Ave. It is adjacent to Shahala middle school. In years past, Mr. Manix worked with the staff from Evergreen School District to implement “20 MPH WHEN FLASHING” speed zones on both SE 1st St and SE 192nd Ave to address pedestrian safety in the area for both school. Both SE 1st St and SE 192nd Ave are busy arterial roadways with big box retail in close proximity. Illahee El School has long been a source of concern of parents due long delays making a left from the school on to SE 1st St. With the proposed development of a new medical office adjacent to the school and installation of a new Costco across the street on SE 1st St, a circulation plan was developed that includes the future construction of SE 193rd Ave/SE 3rd St that will re-route school traffic onto SE 192nd Ave through an existing traffic signal. This circulation plan included a new signal on SE 1st St for Costco that provides access to school buses separate from school traffic. John’s worked through the many details to implement of the circulation plan such as the new signal for Costco and the school bus, the installation of right turn lanes and future design of the proposed SE 193rd/SE 3rd St roadway.

### **STATE SAFE ROUTES TO SCHOOL GRANT FUNDING\***

**Location:** Vancouver, WA

**Client:** Matt Ransom, Long Range Planning Manager, City of Vancouver – 360/487-7707

**Work Services Provided:** *Traffic Engineering*

Within the City of Vancouver Neighborhood Traffic Safety Program, Mr. Manix leveraged City funding to match State Safe Routes to School Grant funding. One of the larger projects included installing walk routes to 4 elementary schools in Vancouver and Evergreen School Districts. This included decorative raised crosswalks, refuge islands, sidewalk improvements and ADA ramps.

### **CLARK COMMUNITY COLLEGE / HUDSON’S BAY HIGH SCHOOL\***

**Location:** Vancouver, WA

**Client:** Ali Eghtedari, Traffic Engineering Manager, City of Vancouver – 360/487-7705

**Work Services Provided:** *Traffic Engineering*

Clark Community College and Hudson’s Bay High School have adjacent campus at the intersection of Fort Vancouver Way and McLoughlin Blvd. Mr. Manix worked with both schools on circulation, parking, bicycle/pedestrian improvements. This included installing pedestrian actuated flashers, diagonal parking, bike lanes and a new Pedestrian Hybrid Beacon (*previously referred to as a HAWK signal*).

*\*under previous employment*



### **SR-503 CHANNELIZATION AND WIDENING PROJECT**

**Location:** Woodland, WA

**Client:** Bart Stepp, Public Works Director, City of Woodland – 360/225-7999

**Work Services Provided:** *Traffic Engineering, Roadway Design*

The SR-503 project for the City of Woodland is currently in the final design and right of way acquisition stage, with construction planned for the summer of 2012. This project consists of acquisition of right-of-way, and the construction of left turn pockets at Hillshire Drive, Insel Road, and Gun Club Road.



HDJ is providing transportation design, project management, traffic analysis, as well as land surveying services. Project management includes oversight and coordination with a large team of sub consultants, WSDOT, and the City of Woodland's Public Works Department.

HDJ's team of sub-consultants is responsible for environmental permitting, ROW acquisition, archeological analysis, and geotechnical analysis.



### **DAVIDSON AVENUE ROADWAY RECONSTRUCTION**

**Location:** Woodland, WA

**Client:** Scott Brunson, Lead Foreman – City of Woodland – 360/225-7999

**Work Services Provided:** *Decorative Street Lighting with Irrigation for Hanging Baskets, Modified Traffic Signal at Fire Station, Roadway Reconstruction, Sanitary Sewer Rehabilitation and Water Quality Treatment Facility*

For the City of Woodland, HDJ offered civil engineering services for 1,800 feet of roadway reconstruction. Davidson Avenue, classified as a two-lane downtown collector, now has a typical section of two lanes, parking on both sides and attached sidewalks. The sidewalks include landscaped areas and tree planters. Crosswalks have improved pedestrian safety due to the incorporation of bulbouts. HDJ completed traffic engineering and analysis including signing and striping, street lighting design and modifications to the existing traffic signal at the fire station.

The sanitary sewer lines along Davidson Avenue were replaced with a new system as part of the design. Water quality treatment was accomplished by incorporating a proprietary device. A complete storm drainage system was installed.

HDJ also provided construction services for this project, including construction contract administration and construction inspection.



### **BOZARTH AVENUE - GEORIG STREET TO FIFTH STREET**

**Location:** Woodland, WA

**Client:** Scott Brunson, Lead Foreman – City of Woodland – 360/225-7999

**Work Services Provided:** *Complete Design and Construction Services, Traffic Engineering and Illumination, Construction Inspection, TIB Funding Requests*

Bozarth Avenue, a 2-lane collector arterial, required 1,500 feet of roadway reconstruction, including sidewalk and curb ramps construction with some curb replacement. The project also included a sanitary sewer rehabilitation with 460 feet of 10-inch and 1,100 feet of 8-inch new sanitary sewer line. The HDJ team designed a complete storm drainage system with a water quality treatment facility and performed traffic engineering and street lighting design.

HDJ also provided complete design and construction services, including construction contract administration, construction inspection, and TIB funding reimbursement requests.



### **STARK STREET TRAFFIC IMPROVEMENTS**

**Location:** Multnomah County, OR

**Client:** Brian Vincent, County Engineer – Multnomah County – 503/998-5050 ext. 29642

**Work Services Provided:** *Estimates for Future Traffic Volume, Traffic Analysis including LOS of 3 traffic signals*

HDJ Design Group provides traffic engineering services to Multnomah County through an on-call professional services contract and one of the projects assigned was for planned improvements on Stark Street. This project is a design for the widening of SE Stark Street between SW 257th Avenue – NE Kane Drive and S Troutdale Road. The County needed traffic engineering input to the design process to ensure that the design will accommodate the expected future traffic conditions. The project is adjacent to the campus of Mt. Hood Community College and the team visited the site to become familiar with traffic conditions, traffic control, land configurations and assessment of the level of internal circulation on the Mt. Hood Campus. The team determined estimates for future traffic volume, and prepared the traffic analysis including the LOS of 3 traffic signals. A final report summarizing the analysis and design recommendations was provided to Multnomah County.



**THOMAS W. DENNIS, P.E.**  
Principal In Charge

As founder of HDJ Design Group, Tom Dennis has provided engineering services on a wide variety of projects within the educational environment since 1980. He has specialized in various aspects of civil engineering design and project planning, team management, scheduling, preparation of construction plans and specifications and contract bidding and construction administration. His technical expertise involves an in-depth review of technical structure and codes for each project to coordinate code requirements on every aspect of the design to bring his projects to an on-time and on-budget conclusion.

Tom has over 35 years of local experience, and has been a key team member within the firm on primary, secondary and collegiate level educational projects. Work projects with Clark College have included: site development, roadway design, grading, erosion control, parking lot design, new building site assessment and drainage issues. Tom has worked in primary and middle school design for the Vancouver and Evergreen School District on a wide variety of projects. His years of experience in engineering design provide familiarity with all local agencies through two decades of change. Over his design career, Tom has perfected his expertise in shepherding projects through local processes and codes, and his long-term knowledge of how these processes work, has proved invaluable, providing his projects with a problem-free conclusion.

**RELEVANT PROJECT EXPERIENCE:**

Woodland School District – Woodland, WA  
 Providence Health & Services Medical Office Campus – Vancouver, WA  
 Columbia River High School – Vancouver, WA  
 Hudson’s Bay High School – Vancouver, WA  
 Alki Middle / Chinook Elementary – Vancouver, WA  
 Fort Vancouver High School – Vancouver, WA  
 Gaiser Middle School – Vancouver, WA  
 Discovery Middle School – Vancouver, WA  
 Pioneer Middle School – Vancouver, WA  
 Kiggins Bowl (VSD) – Vancouver, WA  
 Clark College (Multiple Projects) – Vancouver, WA  
 NW Timmen Road 24” Water Transmission Main – Clark County, WA  
 NE 25th Avenue Sanitary Sewer Rehab and Replacement – Clark County, WA  
 Hazel Ave. North Sanitary Sewer Rehab and Replacement – Clark County, WA  
 Hazel Ave. South Sanitary Sewer Rehab and Replacement – Clark County, WA  
 HDJ Office Expansion – Vancouver, WA  
 Esther Short SubArea Redevelopment Plan and EIS – Vancouver, WA  
 SW Washington Medical Center – Vancouver, WA  
 Vancouver Special Events Center – Vancouver, WA  
 VHA – Uptown Village Green – Vancouver, WA  
 VHA/CNPH Senior Facility – Hazel Dell, WA  
 HDJ Office Building (Phase I and II) – Vancouver, WA  
 Green Mountain Golf Course – Camas, WA  
 Shearwater Condominiums – Princeville, Kauai, Hawaii  
 Bali Hai Condominiums – Princeville, Kauai, Hawaii

**YEARS OF EXPERIENCE: 35**

**EDUCATION**

B.S., Mechanical Engineering  
 - University of Portland  
 Graduate Studies, Civil Engineering  
 - Portland State University

**REGISTRATION**

Licensed Professional Engineer - Washington and Oregon

**PROFESSIONAL AFFILIATIONS**

Member,  
 - American Society of Civil Engineers (ASCE)  
 Active Member,  
 - Vancouver Chamber of Commerce  
 Past President,  
 - ASCE, SW Washington Branch  
 Past Chairman,  
 - Project Review Board City of Vancouver

**YEARS OF EXPERIENCE: 25**

**EDUCATION**

B.S., Civil and Environmental Engineering - California Polytechnic State University - San Luis Obispo  
Chabot Community College - Hayward, CA

**REGISTRATION**

Licensed Professional Engineer - Washington, Oregon and California

Internationally Certified Professional Traffic Operations Engineer

**AWARDS**

Community Leadership Award from Clark County DUI and Traffic Safety Task Force - 2003 & 2004

Silver Spoke Award from the Bicycle Alliance of Washington - 2001

**JOHN A. MANIX, P.E., P.T.O.E.**

**Senior Traffic Engineer**

John Manix is an experienced traffic engineer with more than 25 years of traffic engineering and transportation planning expertise. His broad variety of expertise includes public/private sector projects, as well as experience within the local educational environment. As a previous City employee, past expertise as traffic engineer and transportation planner, John provided professional engineering services to the Long Range Planning and Public Works Department at the City of Vancouver.

John has diverse experience including: traffic impact studies, traffic analysis, school circulation planning and design, safety near schools projects, resolving operational problems at high accident locations, PS&E for neighborhood improvement projects, engineering and transportation planning services for traffic calming, pedestrian and bicycle improvements on over 100 streets within the City, and signing and striping. This wide variety of expertise, and past local experience ensures client satisfaction with a smooth design process from conceptual to completion.

**RELEVANT PROJECT EXPERIENCE:**

Firm Foundation Christian School Expansion – Vancouver WA  
Multnomah County School Safety Review – Multnomah County, OR  
Vancouver Safe Routes to School\* – Vancouver, WA  
Illahee School Circulation Modification\* – Vancouver WA  
Stark Street Traffic Improvements – Multnomah County, OR  
East Vancouver Costco Traffic Signals and Street Lighting\* – Vancouver, WA  
39th Street Pedestrian and Traffic Safety\* – Vancouver, WA  
Mill Plain Pedestrian/Bike Safety\* – Vancouver, WA  
Mill Plain Safety Corridor\* – Vancouver, WA  
SE 15th Street and 176th Avenue (NTS REET)\* – Vancouver, WA  
NE 78th Avenue (NTS REET)\* – Vancouver, WA  
Fourth Plain Safety Corridor\* – Vancouver, WA  
Grand Blvd Road Diet\* – Vancouver, WA  
Fourth Plain Road Diet\* – Vancouver, WA  
Multiple Traffic Calming Projects throughout Vancouver\* – Vancouver, WA

NTS - Neighborhood Traffic Safety, Real Estate Excise Tax

*\*under previous employment*

**JEFFREY R. WISE, P.E., P.T.O.E.**

**Senior Traffic Engineer**

With more than twenty-eight years of experience, 18 of which are specific to traffic engineering, Jeff has been with HDJ for 15 years. He was the assistant SW Region traffic engineer with WSDOT before joining HDJ.

His broad base of experience includes public/private sector projects with inter-agency coordination, such as analyzing impacts of new development on roadway infrastructure, designing traffic appurtenances for local city and county roadway improvements, and recommending capacity and safety improvements on new construction projects.

Jeff has diverse experience, including traffic signal design, concurrency review, resolving operational problems at high accident locations, creating minor capacity improvements, roundabouts, signing and striping, and traffic studies. Jeff has worked with WSDOT and ODOT on past projects, so his familiarity with their requirements makes for a smooth design process.

**RELEVANT PROJECT EXPERIENCE:**

- Woodland School District Capacity Analysis – Woodland, WA
- SR-503 Channelization and Widening – Woodland, WA
- Davidson Avenue – Woodland, WA
- Bozarth Avenue – Woodland, WA
- Union High School (5 Campus) – Vancouver, WA
- Battle Ground School District On-Call Traffic Engineering – Battle Ground, WA
- Amboy Middle School Traffic Study – Amboy, WA
- Area 59 Concept Plan – Sherwood, OR
  - Traffic Studys for future middle and elementary schools in an 85-acre site
- Battle Ground School District Master Plan – Battle Ground, WA
- Cedar Tree Christian Classical School – Clark County, WA
- NE 192nd Avenue & NE 13th Street Signal – Clark County, WA

**YEARS OF EXPERIENCE: 28**

**EDUCATION**

B.S., Civil Engineering  
- Brigham Young University

**REGISTRATION**

Licensed Professional Engineer  
- Oregon, Washington

Internationally Certified Professional Traffic Operations Engineer

**PROFESSIONAL AFFILIATIONS**

Member  
- Institute of Transportation Engineers

**CONTINUING EDUCATION**

Traffic Control Plans Design Workshop - ODOT

Signal Inspector Certification - ODOT

Traffic Signal Loop Detection - WSDOT

Context Sensitive Design - WSDOT

Troubleshooting Roundabout Design - Reid Middleton

Advanced Highway Capacity - Transpeed

Advance Synchro and SimTraffic Training Course - Trafficware

Roundabout Design Concepts and Guidelines - Transpeed

YEARS OF EXPERIENCE: 40+

**LARRY GIFFORD**

**Traffic Designer**

Larry joined HDJ Design Group, P.L.L.C. in September 2001, after thirty plus years of experience with the Washington State Department of Transportation (WSDOT). Larry left HDJ Design Group in 2007 and returned to Washington State Department of Transportation (WSDOT) to work on illumination design for several large interchange projects in the SW region. During his time with WSDOT, Larry was in the WSDOT Traffic Office involved with operational issues (guardrail, signing and striping) and developed cost-effective solutions for high accident locations in the SW Region. Larry was involved in WSDOT signal operations where he created, implemented, and reviewed signal timing plans for isolated signal systems and coordinated corridor signal systems in the SW Region. Larry was involved with illumination layout and design from 2007-2009 for several complex interchange projects with WSDOT in SW Washington.

Since joining HDJ, Larry has been involved in preparing traffic impact analysis for private developments, sign design, signal design and illumination design. Larry has done inspection services on construction projects for WSDOT in Southwest Washington which have included: drainage, grading, signing (permanent and temporary), traffic control, guardrail, asphalt plant and various miscellaneous inspections services. His time spent in the construction field also included contract administration and documentation.

**RELEVANT PROJECT EXPERIENCE:**

- 4th Avenue Corridor – Pasco, WA
- Multnomah County School Safety Review – Multnomah County, OR
- Stark Street Traffic Improvements – Multnomah County, WA
- Innovation Center Phase II – Richland, WA
- NW Lake Road (Illumination) – Camas, WA
- SE 164th Avenue (Illumination) – Vancouver, WA
- SR 4/42nd Avenue (Illumination) – Cowlitz County, WA
- SR 411/ Nevada Drive (Illumination) – Cowlitz County, WA
- Traffic Impact Analysis for several developments – Clark County, WA
- Burton Road (Signal Design) – Vancouver, WA
- Fourth Plain Synchro Analysis (Corridor Operation) – Vancouver, WA
- Hwy 99 Sherwood Synchro Analysis (Corridor Operation) – Sherwood, OR
- I-5 / SR501 Ridgefield Interchange (Illumination) – Ridgefield, WA
- SR 500 St. Johns Interchange (Illumination) – Vancouver, WA
- I-5/SR432 Talley Way Interchange (Illumination) – Vancouver, WA
- I-5/I-205 Salmon Creek Interchange (Illumination Preliminary Layout) – Vancouver, WA

**Art Edgerly**  
Superintendent  
Ridgefield School District  
360/619-1302

**David Commeree**  
Architect  
Firm Foundation Christian School  
360/601-9858

**Brian Vincent**  
County Engineer  
Multnomah County  
503/998-5050 ext. 29642

**Bart Stepp, P.E.**  
Public Works Director  
City of Woodland  
360/225-7999

**Scott Brunson**  
Lead Foreman  
City of Woodland  
360/225-7999

**Kevin Jolma**  
Director of Operations  
Battle Ground School District  
360/885-6677

**John Morris**  
Capital Projects Manager  
Battle Ground School District  
360/885-6626

**John Crist**  
President  
JRC Financial  
719/633-6630

*"I reviewed the signal plans for 162nd/15th today. I wanted to send you an email thanking you for the good job on the signal plans. It is the first one I have reviewed with our new layout and you did a great job. It made it very fast and easy for me to review. There were just a few minor changes needed that I noted on the plans.*

*Again, thanks for the great work!"*

*Chris Christofferson, PE, PTOE  
- City of Vancouver  
Transportation Services*

*"The Port of Kennewick is thankful for the assistance HDJ Design Group, PLLC has provided to help transform Clover Island into the gem of the Tri-Cities. From the roadway reconstruction project of 2006, to the formation of ideas and concepts to stabilize, enhance and create a pathway network along the island's shoreline in 2008 through the celebrated Clover Island Lighthouse, Gateway and West Causeway Enhancement projects of 2010 and 2011, HDJ has provided professional and quality design assistance and construction management."*

*- Larry Peterson  
Director of Planning & Development  
Port of Kennewick, WA*

*"HDJ has provided Gramor with civil engineering services and has gone beyond what is typically expected of a consultant. Because of their high level of professionalism and experience coupled with their personal service and integrity, I have often found them to be an integral member of the development team."*

*- David Copenhaver  
formerly Vice President - Gramor Development  
now Venia West - 360/970-0062*